

> **Materiale di produzione:**
Acciaio S355JR

> **Production material :**
Steel S355JR

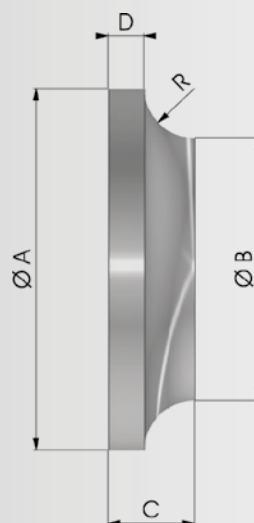

COD.	A	B	C	D	R	Kg
▶ NBFIR0410012	41	27	12	5	7	0,09
▶ NBFIR0510012	51	37	12	5	7	0,15
▶ NBFIR0610015	61	45	15	7	8	0,28
▶ NBFIR0640015	64	48	15	7	8	0,31
▶ NBFIR0660015	66	50	15	7	8	0,33
▶ NBFIR0710015	71	56	15	7,5	7,5	0,39
▶ NBFIR0810017	81	65	17	9	8	0,59
▶ NBFIR0910017	91	75	17	9	8	0,76
▶ NBFIR1010020	101	81	20	10	10	1,07

▶ a richiesta su lotto minimo / on request on a minimum batch