

> **Materiale di produzione:**

Acciaio inox AISI 316L

> **Production material :**

AISI 316 L-type stainless steel

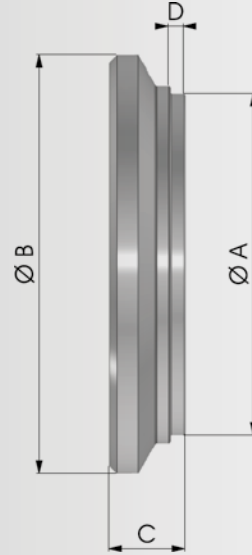

| COD.           | A   | B   | C  | D | Kg   |
|----------------|-----|-----|----|---|------|
| NBFI00040050   | 40  | 50  | 10 | 2 | 0,13 |
| NBFI00050060   | 50  | 60  | 10 | 2 | 0,19 |
| NBFI00060070   | 60  | 70  | 12 | 2 | 0,32 |
| NBFI00070080   | 70  | 80  | 12 | 2 | 0,43 |
| NBFI00080095   | 80  | 95  | 12 | 2 | 0,57 |
| ▶ NBFI00090105 | 90  | 105 | 15 | 2 | 0,90 |
| ▶ NBFI00100115 | 100 | 115 | 15 | 2 | 1,12 |

▶ a richiesta su lotto minimo / on request on a minimum batch