

> **Materiale di produzione:**
Acciaio S355J2C

> **Production material :**
Steel S355J2C

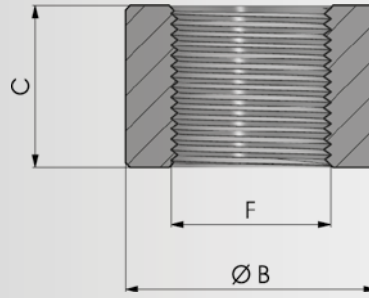

| COD. | F | B | C | Kg |
|--------------|-------|----|----|------|
| NBBORSG1/8 | 1/8" | 19 | 16 | 0,03 |
| NBBORSG1/4 | 1/4" | 22 | 16 | 0,03 |
| NBBORSG3/8 | 3/8" | 26 | 17 | 0,04 |
| NBBORSG1/2 | 1/2" | 30 | 18 | 0,05 |
| NBBORSG3/4 | 3/4" | 36 | 20 | 0,07 |
| NBBORSG1 | 1" | 45 | 25 | 0,15 |
| NBBORSG1-1/4 | 1"1/4 | 55 | 26 | 0,21 |
| NBBORSG1-1/2 | 1"1/2 | 62 | 30 | 0,30 |
| NBBORSG2 | 2" | 75 | 32 | 0,42 |

NBBORSM

> **Materiale di produzione:**
Acciaio S355J2C

> **Production material :**
Steel S355J2C

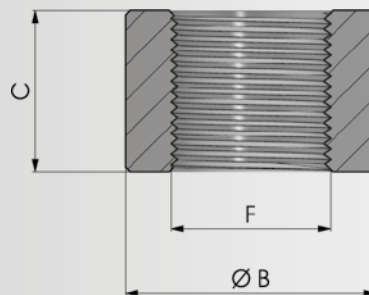

| COD. | F | B | C | Kg |
|-------------|---------|----|------|------|
| NBBORSM1415 | M14X1.5 | 22 | 14 | 0,03 |
| NBBORSM1615 | M16X1.5 | 26 | 17 | 0,03 |
| NBBORSM1815 | M18X1.5 | 28 | 18 | 0,05 |
| NBBORSM2015 | M20X1.5 | 30 | 18 | 0,06 |
| NBBORSM2215 | M22X1.5 | 30 | 18.5 | 0,05 |